

Hackney Road Sculpture Prize



£1000
cash prize

Competition

The Hackney Road Sculpture Prize is an exciting competition to find a new and unique sculpture which will be included in regeneration plans for the Hackney Road. The sculpture will be placed in the heart of a new mixed-use development, providing over 1,000 new local jobs and over 200 new local homes. Leading London developer Regal Homes are keen for the new public realm to be inspiring and reflect this vibrant area's creativity. Competition entries must reflect the theme of 'Regeneration' and be suitable for display in an outside courtyard and able to withstand the weather.

Prize

The winning artist will see their work made and exhibited by Regal Homes on the site of the new development. The winning artist will also receive a cash prize of £1,000. The piece of work must therefore be site specific, reflect the theme of regeneration and be unique and original.

Application

Entrants will need to submit a sketch or model of their design and complete our competition entry form including a short biography (300 words max) about themselves, their work and their inspiration for this piece. Entry forms are available to download from.

www.eastside.org.uk/news/sculpture_prize

Size/Materials

Maximum base size: 1.5m²

Maximum height: 2m high

The piece and materials must be suitable for outside display

The piece must be appropriate for all ages

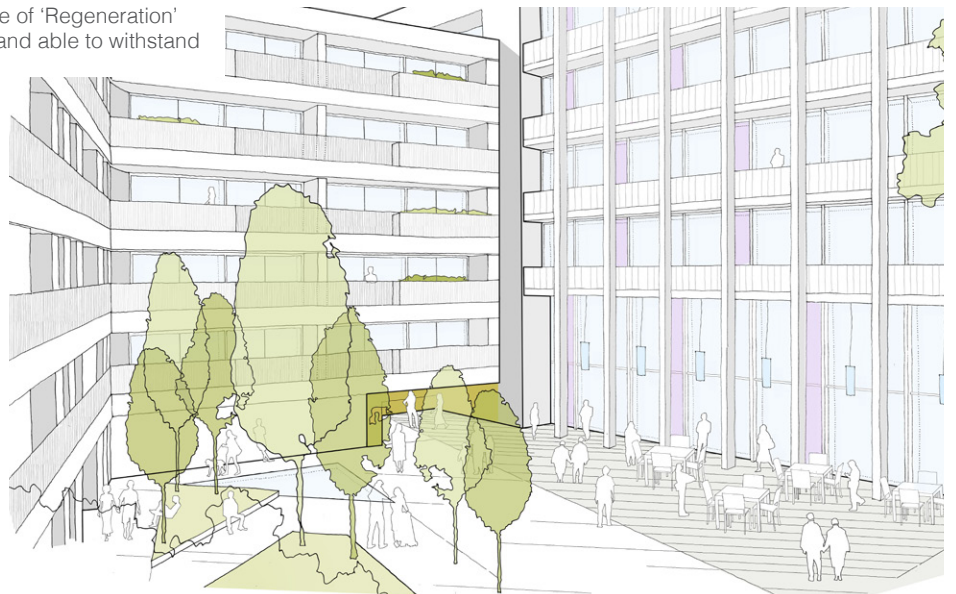

Eastside is a professional organisation with creativity at its heart, inspiring young people from different backgrounds to discover their individual talents through creative workshops and sessions. We provide professional participatory workshops and guidance for all young people across the entire spectrum of the arts including: drama and performance, dance and movement, literature and spoken word, visual arts and crafts, music and singing and film and media, both in-school-time and out-of-school-hours. Our educational outreach programme actively targets those that are disadvantaged or disaffected and young people that have special educational needs, learning difficulties or disabilities.

www.eastside.org.uk

Regal Homes have been building high quality homes in the London market since 1998, earning a reputation as a leading London developer. The company has completed over 1,000 residential units, all of which have a hallmark of quality. To ensure quality, Regal Homes build their own projects, giving them control over all stages of the construction process. Each project is meticulously managed from start to finish by an in-house team. Regal Homes only build in London and developments are situated in regeneration areas near transportation hubs where the design and quality developments brings benefit to the community.

The Hackney Road Sculpture Prize is supported by Regal Homes
<http://regal-homes.co.uk/>



Competition Rules

Entrants must be aged 18 and over
Entrants must currently reside in the UK
Designs must be for a new sculpture.
Work that has already been constructed will not be accepted.
Entrants must present designs of their own origin and must hold the moral and intellectual copyright to the work and designs
Entrants must submit sketches, photos or models of work, not the actual piece
Entrants may submit up to 3 sculpture designs
Entries must be submitted by 5pm on Monday 31st August.
The selection panel will not consider work submitted after this deadline
The judge's decision is final
A maximum of £2,500 will be set aside to commission the winning artist to make the sculpture.

Once a winner is selected, they will meet with the Directors of Regal Homes to discuss the inclusion of their sculpture within the scheme.

All correspondence with the winning artist will be by email, unless specifically stated otherwise

IMPORTANT: If your work differs dramatically on completion from the designs submitted to the competition, Regal Homes retain the right to reject the piece and award the prize to another participating artist
The winning artist will retain the copyright of the design, but the sculpture will be owned by Regal Homes

Regal Homes retains the right to use photographs of the sculpture for the publicity and promotion of the competition and Regal Homes development or to sell the sculpture for profit